

IEC 61557-12 PMD/DD/K55/1

PowerTags are energy sensor modules for 1P, 1P+N, 3P and 3P+N networks. They are mounted directly on equipment of the Acti 9 or Multi 9 range at intervals of 18 mm up to 63 A.

Functions

Combined with Acti 9 Smartlink SI B (Ethernet) or Acti 9 Smartlink SI D (Ethernet) by radio-frequency communication, PowerTag sensors measure the following values in accordance with the IEC 61557-12 standard

- Cumulative active energy, total and partial (kWh).
- Rms values:
 - phase-to-neutral and phase-to-phase voltages (V),
 - currents per phase (A),
 - total active power and active power per phase (W),
 - power factor.

Installed upstream or downstream of a protective device, they measure useful data for diagnosis of the associated circuit.

Configuration

- Recognition of the device in the Acti 9 Smart Test configuration software: the product flashes in the switchboard during configuration for easy recognition.
- Addition of context-related information to Acti 9 Smart Test (name of the load, energy usage, single-line circuit label).
- Partial energy counter can be reset or preset to a special value via the software.

Integration in Acti 9 Smartlink

- Use of a wireless concentrator to report data:
 - Acti 9 Smartlink SI B (Ethernet) for a complete metering, monitoring and control solution,
 - Acti 9 Smartlink SI D (Ethernet) for a metering and monitoring solution only.
- Native display, in Smartlink's embedded web pages, of the quantities measured by the PowerTag sensors.
- Load monitoring
 - alarm sent by the sensor in the event of a voltage loss,
 - pre-alarms on predefined thresholds (50 %, 80 %) or customized thresholds (thresholds on currents, power, voltages and cumulative energies).
- Alarm management on current/voltage/load level thresholds by e-mail.
- Display of alarms and pre-alarms on Smartlink embedded web pages.
- Easy integration into system with Com'X200, Com'X 510 and other Schneider Electric software and third-party Building Management Systems (BMS's) thanks to the Acti 9 Smart Test report in Excel format. This report provides dynamically all the Modbus registers, including bits and meanings associated, for an easy integration into the software.
- Remote metering possible using the Smartlink monitoring page.

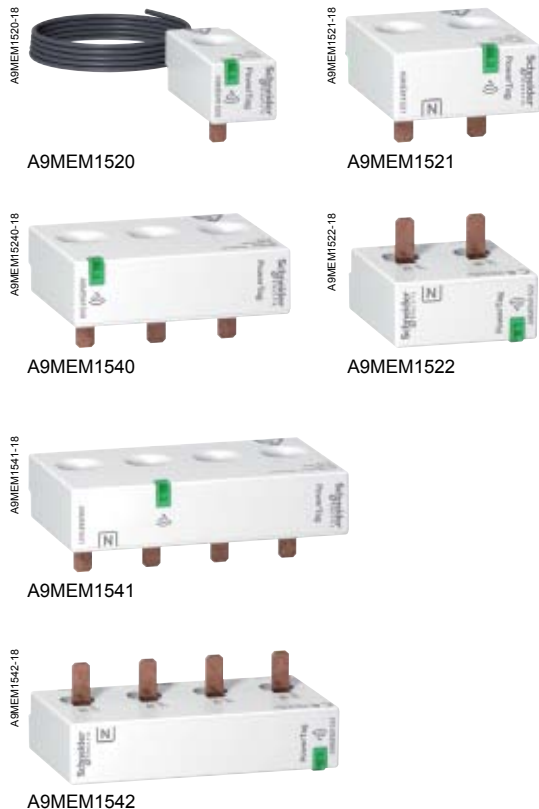

Test software: Acti 9 Smart Test

- Electrical continuity test (cabling of connected devices)
- Communication Testing of wired, wireless devices, analog and Modbus devices..
- Editing of a complete test report (Excel, pdf) with the Modbus communication registers for easy integration into a supervision system
- Windows XP, Windows 7, Windows 8 and Windows 10 compatible
- Downloadable from: schneider-electric.com



Catalogue numbers

PowerTag		
Type	Type of mounting	Cat. no.
1P	Top and bottom	A9MEM1520
1P+N	Top	A9MEM1521
	Bottom	A9MEM1522
3P	Top and bottom	A9MEM1540
3P+N	Top	A9MEM1541
	Bottom	A9MEM1542



> Metering and monitoring and control

Acti 9 Smartlink SI B (Ethernet)

PB113286-175



Embedded web pages

- Monitoring display
- Alarm management and display
- E-mail sending

Integrated Modbus
gateway

Channels for monitoring/ control

- Contactors, OF/SD devices,
analog sensors

Compatible products

"Single terminal" circuit breakers and switches at
intervals of 18 mm, ratings less than or equal to 63 A:

- Acti 9 : iC60/iID/iID K/iSW (< 63 A)/iSW-NA/
Reflex iC60/iK60/i65N-K
 - Multi9 : C32/C45/C60/K60/iD/iSW/I-NA
 - DT60
- See catalogue module CA908058



PB115447-40



PowerTag

- Radio frequency communication
- Up to 20 sensors connected

> Metering and monitoring only

Acti 9 Smartlink SI D (Ethernet)

Embedded web pages

- Monitoring display
- Alarm management and display
- E-mail sending

A9XMMWA20-35



PowerTag

- Radio frequency communication
- Up to 20 sensors connected

- Installation on DIN rail
- 230 V AC power supply

Compatible products

"Single terminal" circuit breakers and
switches at intervals of 18 mm, ratings
less than or equal to 63 A:

- Acti 9 : iC60/iID/iID K/iSW (< 63 A)/
iSW-NA/Reflex iC60/iK60/i65N-K
 - Multi9 : C32/C45/C60/K60/iD/
iSW/I-NA
 - DT60
- See catalogue module CA908058

PB115447-40





Technical characteristics

Main characteristics

Rated voltage	Un	Phase-to-neutral	230 V AC ± 20 %
		Phase-to-phase	400 V AC ± 20 %
Frequency			50/60 Hz
Maximum operating current	Imax	63 A	
Saturation current			130 A
Maximum consumption			≤ 2 VA
Starting current	Ist	40 mA	
Base current	Ib	10 A	

Additional characteristics

Operating temperature			-25°C to +60°C
Storage temperature			-40°C to +85°C
Overvoltage category	As per IEC 61010-1		Cat. III
Measuring category	As per IEC 61010-2-30		Cat. III
Pollution degree			3
Altitude			\leq 2000 m
Degree of protection	Device only		IP20
	IK		05

Radio-frequency communication

ISM band 2.4 GHz			2.4 GHz to 2.4835 GHz
Channels	As per IEEE 802.15.4		11 to 26
Isotropic Radiated Power	Equivalent (EIRP)		0 dBm
Maximum transmission time			< 5ms
Channel occupancy	For 1 device		Messages sent every 5 seconds

Characteristics of measuring functions

Function	Performance category as per IEC 61557-12		
Active power	P	1	9 W to 63 kW
Active energy	Ea	1	Total and partial 0 to 99999999.9 kWh
Current	I	1	2 A to 63 A
Voltage	U	0.5	Un \pm 20 %
Power factor	PFA	1	0 to 1

Connection

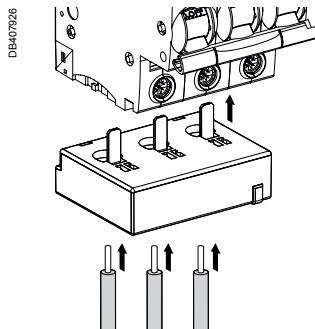

Stripping length	Copper cables					
	Rigid		Flexible		Flexible with ferrule	
	DB122945	DB12804	DB123553	DB12805	DB123554	DB123008
18 mm ^(*)	1.5 to 16 mm ²	2 x 1.5 to 2.5 mm ²	1.5 to 16 mm ²	2 x 1.5 to 2.5 mm ²	-	-
18 mm	-	-	-	-	1.5 to 16 mm ²	2 x 1.5 to 2.5 mm ²

■ Mounting with 18 mm ferrule recommended.

■ (*) Without ferrule/cable ends, respect the stripping length stated on the associated products.

Dimensions (mm)

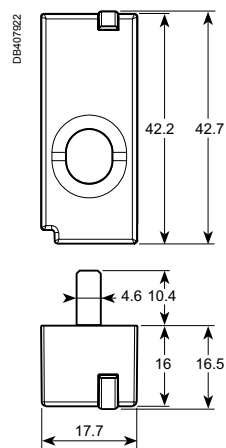

1P

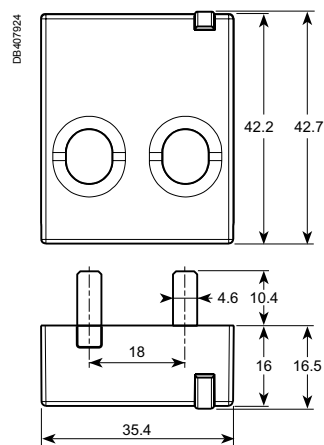

1P+N

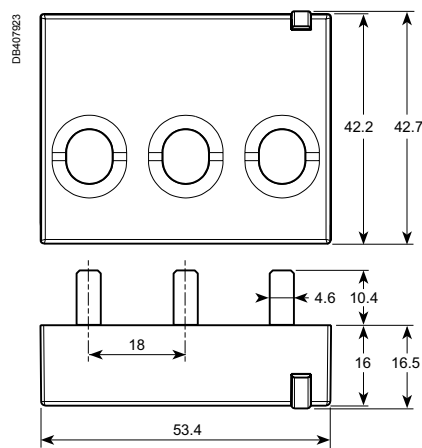

3P

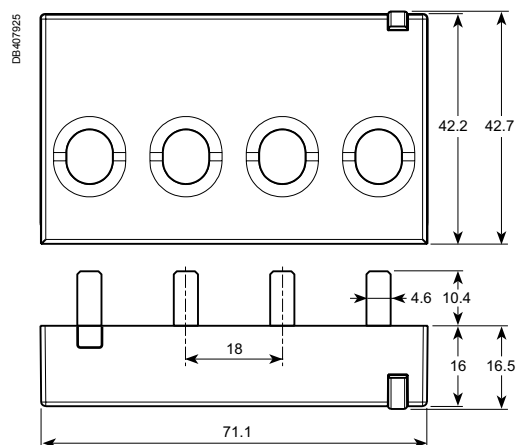

3P+N

Weight (g)

PowerTag	
Type	
1P	16.4
1P+N	17.5
3P	28
3P+N	35



1.0	31/08/2015	Creation	Sonovision
Indice	Date	Modification	Name